



10 , Morris Road, Whitwood, Castleford, West Yorkshire, WF10 5GP

Property Features

Property Summary

Oakleaf homes are pleased to offer this two bedroom coach house, with family bathroom, lounge and fully fitted kitchen. The property is offered with NO ONWARD CHAIN. Call our office now to arrange your viewing.

Price
**Offers in the region
of £99,950**

Speak with our Sales
Adviser Today to Arrange a
Viewing!

OAKLEAF HOMES
Older homes backed by Barratt.

www.oakleafhomes.co.uk

0161 855 2855

These particulars are intended only as general guidance. The Company therefore gives notice that none of the material issued or visual depictions of any kind made on behalf of the Company can be relied upon as accurately describing any of the Specified Matters prescribed by any Order made under the Property Misdescriptions Act 1991. Nor do they constitute a contract, part of a contractor or warranty. *Estimated rental yield figures are calculated using information supplied by the marketing agent and are based on the original market price. The rental yield figure should only be used as a guide and we strongly recommend you seek independent financial advice before proceeding with any investment.

Oakleaf homes are pleased to offer this two bedroom coach house, with family bathroom, lounge and fully fitted kitchen. The property is offered with NO ONWARD CHAIN. Call our office now to arrange your viewing.

Lounge 5.34 m x 3.87 m

With double glazed window, velux window and radiator.

Kitchen 2.49 m x 2.35 m

Having a range of fitted base and wall units.

Bed 2 3.51 m x 2.23 m

With double glazed window and radiator.

Bed 1 3.61 m x 3.01 m

With double glazed window and radiator.

Bathroom 2.04 m x 1.67 m

Having a three piece suite in white with low level w.c, pedestal wash hand basin and panelled bath. Partly tiled walls, and radiator.

Floorplans

First Floor

Approx. 57.0 sq. metres (613.8 sq. feet)

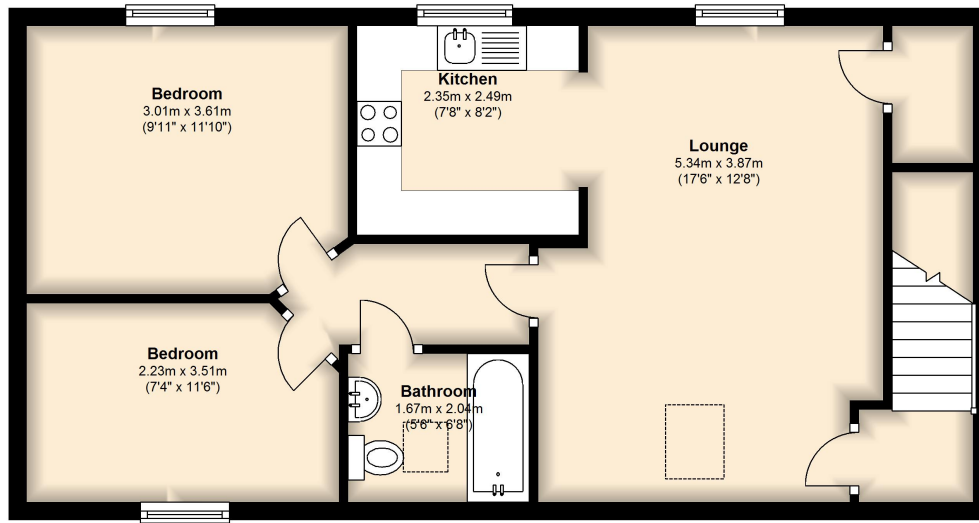

Total area: approx. 57.0 sq. metres (613.8 sq. feet)

Whilst every attempt has been made to ensure the accuracy of the floor plan contained here, measurements of doors, windows, rooms and any other items are approximate and no responsibility is taken for any error, omission, or mis-statement. This plan is for illustrative purposes only and should be used as such by any prospective purchaser.
Plan produced using PlanUp.

Map

