



**Bedford Road, Hessle, Hull, East Yorkshire,
HU13**

Price
£99,950

Property Features

- Established Terraced Family Home
- NEW DECOR AND CARPETS THROUGHOUT
- Popular Residential Location
- Spacious Open Plan Lounge Dining Room
- Kitchen to Rear
- Two First Floor Double Bedrooms
- First Floor Bathroom
- Useful Loftroom with Velux Window
- Garden and Garage
- IDEAL FIRST TIME BUY / INVESTMENT

Speak with our Sales
Adviser Today to Arrange a
Viewing!

Property Summary

EXCELLENT VALUE FOR MONEY - BUY TODAY,
HASSLE FREE This established terraced property,
situated in this popular residential area, would make
an ideal First Time Home, with new decor and
carpets and accommodation comprising lounge
diner, kitchen, two bedrooms, bathroom, loftroom
and garage INTERNAL INSPECTION A MUST!!!

OAKLEAF HOMES
Older homes backed by Barratt.

www.oakleafhomes.co.uk

07843 368 704

These particulars are intended only as general guidance. The Company therefore gives notice that none of the material issued or visual depictions of any kind made on behalf of the Company can be relied upon as accurately describing any of the Specified Matters prescribed by any Order made under the Property Misdescriptions Act 1991. Nor do they constitute a contract, part of a contract or warranty. *Estimated rental yield figures are calculated using information supplied by the marketing agent and are based on the original market price. The rental yield figure should only be used as a guide and we strongly recommend you seek independent financial advice before proceeding with any investment.

EXCELLENT VALUE FOR MONEY - BUY TODAY, HASSLE FREE

This established terraced property, situated in this popular residential area, would make an ideal First Time Home, with new decor and carpets and accommodation comprising lounge diner, kitchen, two bedrooms, bathroom, loftroom and garage
INTERNAL INSPECTION A MUST!!!

Bedford Road, HESSLE, HU13 9DQ

Ground Floor

Living Room 4.65m (15'3") max x 3.27m (10'9") max

Double glazed box window to front, decorative fitted coal effect fire with surround and marble effect hearth, radiator, fitted carpet, dado rail, open plan,

Dining Room 4.63m (15'2") x 2.59m (8'6")

Radiator, fitted carpet, dado rail, three-way ceiling light,

Kitchen 3.54m (11'7") x 2.68m (8'10")

Fitted with a matching range of base and eye level units with worktop space over cupboards, 1+1/2 bowl stainless steel sink with single drainer and mixer tap, space for fridge/freezer, fitted gas cooker oven, four ring gas hob, double glazed window to rear, tiled flooring,

First Floor

Bedroom 1 4.63m (15'2") max x 3.60m (11'10") max

Two double glazed windows to front, three fitted wardrobes, fitted carpet, ceiling light, stairs,

Bedroom 2 2.84m (9'4") max x 2.74m (9') max

Double glazed window to rear, radiator, fitted carpet, ceiling light,

Bathroom

Fitted with four piece suite comprising panelled bath with hand shower attachment, pedestal wash hand basin, shower cubicle with fitted shower and glass screen and WC, full height ceramic tiling to all walls, wall mounted mirror, frosted double glazed window to rear, radiator, tiled flooring, d

Second Floor

Loft Room 4.19m (13'9") x 2.57m (8'5")

Double glazed skylight, fitted carpet.

Floorplans

Ground Floor

Approx. 40.9 sq. metres (439.7 sq. feet)

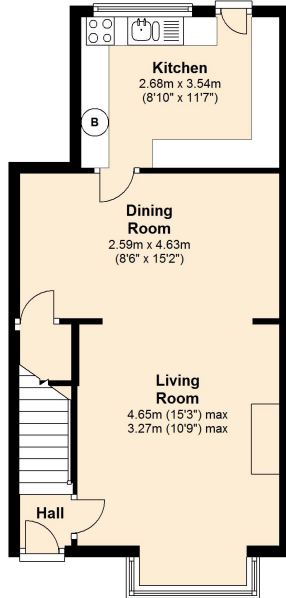

First Floor

Approx. 30.1 sq. metres (323.9 sq. feet)

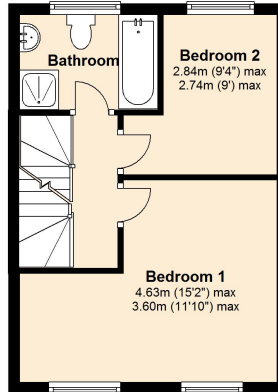

Second Floor

Approx. 10.8 sq. metres (115.9 sq. feet)

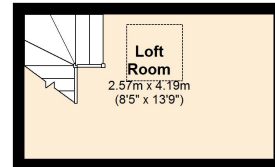

Total area: approx. 81.7 sq. metres (879.5 sq. feet)

This floor plan is for illustrative purposes only and is not to scale. Where measurements are shown, these are approximate and should not be relied upon. Total square area includes the entirety of the property and any outbuildings/garages. Sanitary ware and kitchen fittings are representative only and approximate to actual position, shape and style. No liability is accepted in respect of any consequential loss arising from the use of this plan. Reproduced under licence from Evolve Partnership Limited. All rights reserved. Plan produced using PlanUp.

Map

