



14 , Dyrham Court, Redhouse, Swindon, SN25 2FY

Price
£229,500

Property Features

- RECENTLY REDUCED FROM £238,995
- NO ONWARD CHAIN!
- Three Bedrooms
- Garage & Parking
- Beautiful Garden
- Downstairs WC
- En-Suite to Master Bedroom

Speak with our Sales Adviser Today to Arrange a Viewing!

Property Summary

A THREE BEDROOM end terrace home benefiting from an EN-SUITE & GARAGE. There is also a GOOD SIZE sitting room and kitchen dining room. Within walking distance of Redhouse Village Centre, Orbital Shopping Centre and schooling. Excellent access to the M4 Motorway and A419. Call 01454 628990 to arrange a viewing!

OAKLEAF HOMES
Older homes backed by Barratt.

www.oakleafhomes.co.uk

01454
628990

These particulars are intended only as general guidance. The Company therefore gives notice that none of the material issued or visual depictions of any kind made on behalf of the Company can be relied upon as accurately describing any of the Specified Matters prescribed by any Order made under the Property Misdescriptions Act 1991. Nor do they constitute a contract, part of a contract or warranty. *Estimated rental yield figures are calculated using information supplied by the marketing agent and are based on the original market price. The rental yield figure should only be used as a guide and we strongly recommend you seek independent financial advice before proceeding with any investment.

A THREE BEDROOM end terrace home benefiting from an EN-SUITE & GARAGE. There is also a GOOD SIZE sitting room and kitchen dining room. Within walking distance of Redhouse Village Centre, Orbital Shopping Centre and schooling. Excellent access to the M4 Motorway and A419. Call 01454 628990 to arrange a viewing!

Floorplans

Ground Floor

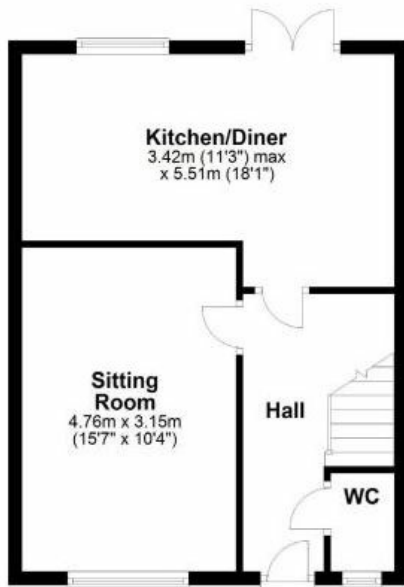

First Floor

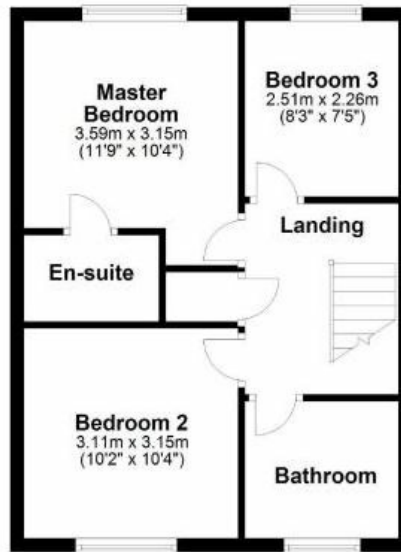

Map

