



**67 , Saltmeadows , , Nantwich, Cheshire, CW5 5HF**

Price  
**£299,995**

### Property Features

- PART EXCHANGE CONSIDERED
- NO ONWARD CHAIN
- WELL PRESENTED
- EN-SUITE TO MASTER BEDROOM
- VIEWING HIGHLY RECOMMENDED

Speak with our Sales Adviser  
Today to Arrange a Viewing!

### Property Summary

Oakleaf Homes are happy to offer for sale this 4 bedroom Detached family home. Viewing is highly recommended so dont miss out. Call Margie on 01925 846602

**OAKLEAF HOMES**  
Older homes backed by Barratt.

[www.oakleafhomes.co.uk](http://www.oakleafhomes.co.uk)

01925 846 602

These particulars are intended only as general guidance. The Company therefore gives notice that none of the material issued or visual depictions of any kind made on behalf of the Company can be relied upon as accurately describing any of the Specified Matters prescribed by any Order made under the Property Misdescriptions Act 1991. Nor do they constitute a contract, part of a contractor or warranty. \*Estimated rental yield figures are calculated using information supplied by the marketing agent and are based on the original market price. The rental yield figure should only be used as a guide and we strongly recommend you seek independent financial advice before proceeding with any investment.

Oakleaf Homes are happy to offer for sale this 4 bedroom Detached family home. Viewing is highly recommended so don't miss out. Call Margie on 01925 846602

**67 Salt Meadow, Nantwich, CW5 5HF**

\* 4 Bedrooms

\* 2 Receptions

\* Fitted Kitchen/Diner

\* En-suite Shower Room

\* Conservatory

\* Down stairs WC

\* Family bathroom

\* Garage

**Ground Floor**

**Hall**

Double radiator, fitted carpet with two ceiling lights, stairs leading to upstairs and doors leading to dining room, WC, kitchen/diner and lounge.

**Dining Room 2.80m (9'2") x 2.60m (8'6")**

Double glazed window to front, radiator, fitted carpet, coving to ceiling with ceiling light.

**Kitchen/Diner 4.30m (14'1") x 2.60m (8'6")**

Fitted with a range of base and eye level units with worktop space over, 1+1/2 bowl stainless steel sink unit with single drainer and mixer tap, integrated fridge/freezer and dishwasher, fitted electric oven, built-in five ring gas hob with extractor hood, double glazed window to rear, radiator, vinyl flooring with ceiling spotlights, door leading to utility.

**Utility 1.80m (5'11") x 1.70m (5'7")**

Fitted with a range of base and eye level units with worktop space over with worktop space over, stainless steel sink unit with single drainer and mixer tap, space for tumble dryer, radiator, vinyl flooring with ceiling light, door leading to side of property.

**WC**

Two piece suite wash hand basin and low-level WC, tiled splashback, radiator, fitted carpet with ceiling light.

**Lounge 4.50m (14'9") max x 4.30m (14'1")**

Double glazed window to rear, fireplace set in timber surround, fitted carpet, coving to ceiling with ceiling light, patio door to Conservatory.

**Conservatory**

Half brick with uPVC double glazed windows and double glazed, two double glazed windows to side, double glazed window to rear, window to side, tiled flooring, patio door leading to rear of property.

## **First Floor**

### **Landing**

Radiator, fitted carpet with ceiling light, doors leading to bathroom and bedrooms.

### **Bedroom 3 3.30m (10'10") x 3.00m (9'10")**

Double glazed window to rear, radiator, fitted carpet with ceiling light.

### **Bathroom**

Three piece suite comprising panelled bath, pedestal wash hand basin and low-level WC, tiled splashbacks, double glazed window to side, radiator, fitted carpet with ceiling light.

### **Bedroom 1 4.20m (13'10") max x 3.30m (10'10")**

Double glazed window to rear, fitted bedroom suite comprising built-in wardrobe(s), radiator, fitted carpet, coving to ceiling with ceiling light, folding door, door leading to En-suite shower room.

### **En-suite Shower Room**

Shower, wash hand basin and WC tiled surround, double glazed window to side, heated towel rail, tiled flooring with ceiling spotlights.

### **Bedroom 4 2.50m (8'2") x 2.30m (7'6")**

Window to front, radiator, fitted carpet with ceiling light.

### **Bedroom 2 3.80m (12'6") x 3.79m (12'5")**

Double glazed window to front, radiator, fitted carpet with ceiling light.

## **External**

### **Rear**

Grass turf area.

### **Front**

Off street parking, grass turf area, patio path leading to front door, garage.

## **67 Salt Meadow, Nantwich, CW5 5HF**

\* 4 Bedrooms

\* 2 Receptions

\* Fitted Kitchen/Diner

\* En-suite Shower Room

\* Conservatory

\* Down stairs WC

\* Family bathroom

\* Garage

## **Ground Floor**

### **Hall**

Double radiator, fitted carpet with two ceiling lights, stairs leading to upstairs and doors leading to dining room, WC, kitchen/diner and lounge.

### **Dining Room 2.80m (9'2") x 2.60m (8'6")**

Double glazed window to front, radiator, fitted carpet, coving to ceiling with ceiling light.

### **Kitchen/Diner 4.30m (14'1") x 2.60m (8'6")**

Fitted with a range of base and eye level units with worktop space over, 1+1/2 bowl stainless steel sink unit with single drainer and mixer tap, integrated fridge/freezer and dishwasher, fitted electric oven, built-in five ring gas hob with extractor hood, double glazed window to rear, radiator, vinyl flooring with ceiling spotlights, door leading to utility.

### **Utility 1.80m (5'11") x 1.70m (5'7")**

Fitted with a range of base and eye level units with worktop space over with worktop space over, stainless steel sink unit with single drainer and mixer tap, space for tumble dryer, radiator, vinyl flooring with ceiling light, door leading to side of property.

### **WC**

Two piece suite wash hand basin and low-level WC, tiled splashback, radiator, fitted carpet with ceiling light.

**Lounge 4.50m (14'9") max x 4.30m (14'1")**

Double glazed window to rear, fireplace set in timber surround, fitted carpet, coving to ceiling with ceiling light, patio door to Conservatory.

**Conservatory**

Half brick with uPVC double glazed windows and double glazed, two double glazed windows to side, double glazed window to rear, window to side, tiled flooring, patio door leading to rear of property.

**First Floor**

**Landing**

Radiator, fitted carpet with ceiling light, doors leading to bathroom and bedrooms.

**Bedroom 3 3.30m (10'10") x 3.00m (9'10")**

Double glazed window to rear, radiator, fitted carpet with ceiling light.

**Bathroom**

Three piece suite comprising panelled bath, pedestal wash hand basin and low-level WC, tiled splashbacks, double glazed window to side, radiator, fitted carpet with ceiling light.

**Bedroom 1 4.20m (13'10") max x 3.30m (10'10")**

Double glazed window to rear, fitted bedroom suite comprising built-in wardrobe(s), radiator, fitted carpet, coving to ceiling with ceiling light, folding door, door leading to En-suite shower room.

### **En-suite Shower Room**

Shower, wash hand basin and WC tiled surround, double glazed window to side, heated towel rail, tiled flooring with ceiling spotlights.

### **Bedroom 4 2.50m (8'2") x 2.30m (7'6")**

Window to front, radiator, fitted carpet with ceiling light.

### **Bedroom 2 3.80m (12'6") x 3.79m (12'5")**

Double glazed window to front, radiator, fitted carpet with ceiling light.

### **External**

#### **Rear**

Grass turf area.

#### **Front**

Off street parking, grass turf area, patio path leading to front door, garage.



# Floorplans

Ground Floor



First Floor

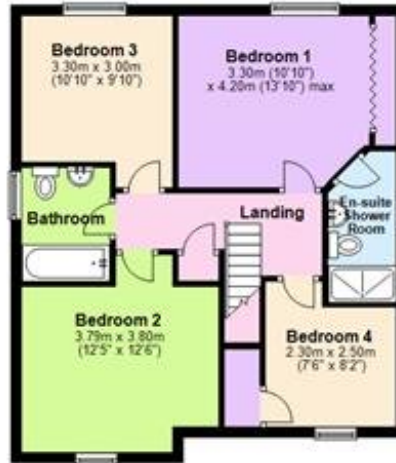

This floor plan is for illustrative purposes only and is not to scale. Where measurements are shown, these are approximate and should not be relied upon. Total square area includes the entirety of the property and any outbuildings/garages. Sanitary ware and kitchen fittings are representative only and approximate to actual position, shape and style. No liability is accepted in respect of any consequential loss arising from use of this plan. Reproduced under license from Evolve Partnership Limited. All rights reserved.  
Plan produced using PlanIt.

## Map

□